

EasyPatch

CGM System (Nano)

Quick Start Guide (mmol/L)

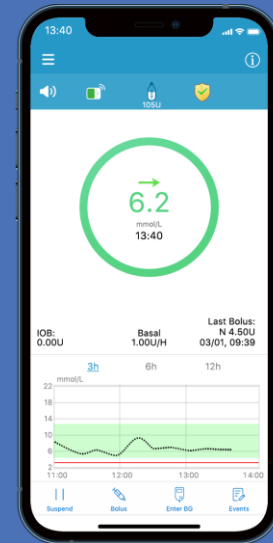

www.medtrum.com

Simplifying Diabetes

Medtrum

Contents

EasyPatch App Overview	1
Smart Device Settings	3
Install and Login	4
Register a Medtrum Account	5
Monitor Screen and Main Menu	6
System Settings	7
Alert Settings	8
Apply Sensor	9
Start Sensor	11
Read CGM	12
Disconnect Sensor	14
Statistics	15
Events and Personal Reminders	16
Your Personal CGM Settings	17

EasyPatch App Overview

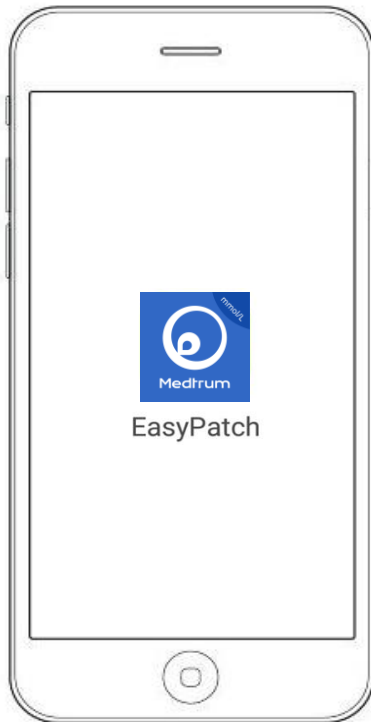

The mobile CGM System consists of:

- **Smart device with Medtrum EasyPatch mobile App installed**
- **Continuous Glucose Sensing System**

The Medtrum EasyPatch mobile App monitors and controls your Continuous Glucose Monitoring System via Bluetooth. It provides you with Sensor data of the last 90 days.

Bluetooth communication is essential for the EasyPatch App to control/monitor the Continuous Glucose Sensing System. The App can detect and notify you about a disconnection.

When the communication is lost, the Transmitter can continue to record sensor glucose readings.

The App can be used normally when your smart device is charged and turned-on. If the phone is turned off, as soon as restart your smart device and the App, the App will automatically connect with the Glucose Monitoring System.

EasyPatch App Overview

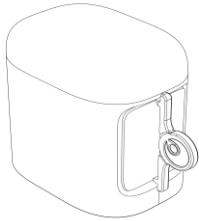

Glucose Sensor



Transmitter

- The Glucose Sensor (for 14 days) is inserted under the skin to measure your glucose level in interstitial fluid.
- The Transmitter records Sensor data and sends data to your smart device via Bluetooth Low Energy
- The Sensor (with Transmitter snapped in) is waterproof at 2.5 meters (8 feet) for 60 minutes (IP28).
- Store the Sensor at temperatures between 2°C (36°F) and 30°C (86°F).
- Store the Transmitter at temperatures between -10°C (14°F) and 55°C (131°F).

Charge Transmitter

- You can use a Transmitter charging cable to charge the Transmitter.
- It is recommended to charge the Transmitter after each sensor use.
- Do NOT store the Transmitter connected with a Sensor or a USB charging cable. That may kill the transmitter battery.
- The indicator light will flash green when the Transmitter is charging, and turn off when the Transmitter is fully charged.

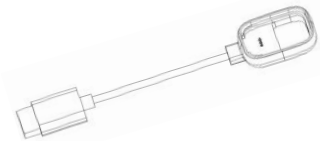

USB Charging Cable

Smart Device Requirements

- IOS device: IOS 12.0 system or later
- Android device: Android 8.0 system or later

Set the following for your EasyPatch App:

- Bluetooth: Available and turn on
- Silent and Do Not Disturb: Turn off
- Volume: Loud enough for you to hear alerts and reminders.
- Internet: Make sure your smart device settings allow EasyPatch App to use WLAN and mobile data.
- Camera: Grant EasyPatch access to camera.
- Notifications: Turn on notifications for the EasyPatch App.
- Time: Do not change your smart device's time because it can make the time on the monitor screen wrong.
- Battery saver mode: Do not activate low battery usage mode. Otherwise, the app will stop uploading data in the background.
- EasyPatch App is open and running in the background.
- Restart the EasyPatch App after your smart device is restarted.

Recommended Smart Device Settings

See your smart device instructions to learn how to change its settings.

If you installed the App on an IOS device:

- Make sure the background refresh for EasyPatch App is turned on.

If you installed the App on an Android device:

- For Android system 8.0 to 11.0, make sure you allow the App to access device's location so that the App can use the Bluetooth feature.
- For Android 12.0 system or later, make sure you turn on Nearby Devices so that the App can use the Bluetooth feature to connect other device.
- Make sure the EasyPatch App is locked in the background.
- Open auto run in the Smart Manager (Samsung).

Install and Login

1. Download and install EasyPatch App

Search “Medtrum” in App Store or Google Play

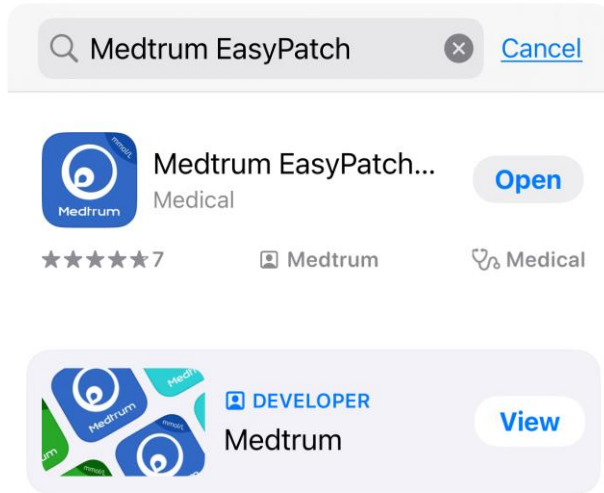

2. Open the Medtrum EasyPatch App

3. Log in a Medtrum account

If you already have a Medtrum account, ensure that the correct country/region is selected for your account. To do this, tap the **country/region** name in the top-right corner of the screen and select the appropriate option from the list.

Next, enter your **email address** and **password** to log in. If you've forgotten your password, tap **Forgot password?** to reset the password.

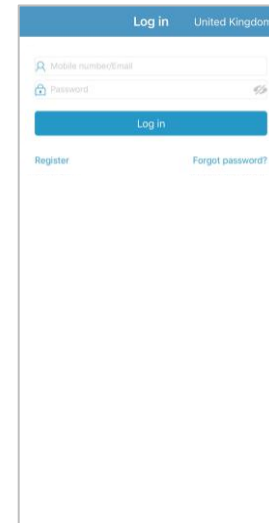

Register a Medtrum Account

1. Agree to Privacy Policy and Terms of Use

If you do not have a Medtrum account, first tap on the country/region name in the top right corner to ensure you have selected the correct country/region for your account.

Back on the login page, tap Register.

Read and agree to the Privacy Policy and Terms of Use by ticking the small boxes and tap Next to start registration.

The first screenshot shows the 'Register' screen with a privacy policy and terms of use notice. It includes checkboxes for 'I Agree to the Privacy Policy of Medtrum' and 'I Agree to the Terms of Use of Medtrum'. A 'Next' button is at the bottom.

The second screenshot shows the 'Register' screen with input fields for country (United Kingdom), language (English), email address, verification code, full name, and password. A 'Get Code' button is next to the email field. A 'Submit' button is at the bottom.

2. Enter Email Address and Verification Code

Enter your email address as your account name. Tap **Get Code** and you will receive a 6-digit verification code in the email address. Check your email and enter the 6-digit verification code on the registration page.

3. Fill out Your Full Name and Set Password

Fill out your full name so that your healthcare providers can identify you easily.

Set the password for your account.

✓ The password must contain characters from three of the following four categories:

- English uppercase characters (A through Z)
- English lowercase characters (a through z)
- Base 10 digits (0 through 9)
- Non-alphabetic characters, including ~!@#\$%^&*()_ - += `{}|[]\';<>.,.

✓ The password must be between 6 and 20 characters long.

✓ The password must be different from your username (your email address).

✓ The password cannot contain 3 consecutive numbers (eg: 123, 321).

✓ The password cannot contain 3 consecutive letters (eg: abc, cba).

✓ The password cannot contain spaces.

Tap Submit to complete account registration.

Monitor Screen and Main Menu

Main Menu

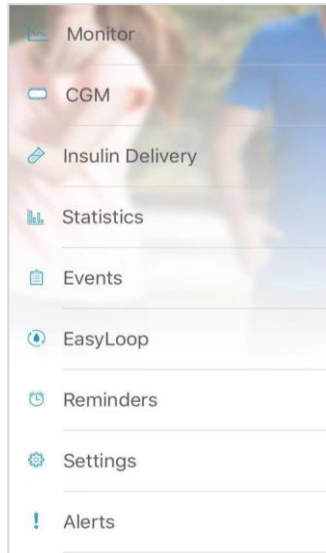

Monitor Screen

Not Connected

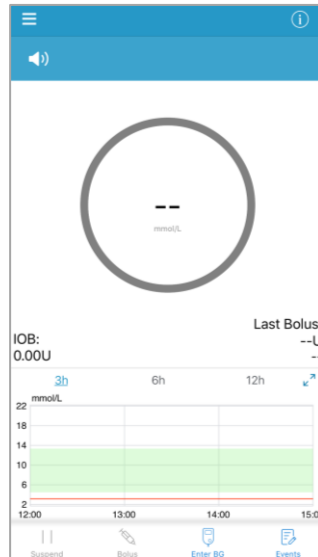

Connected

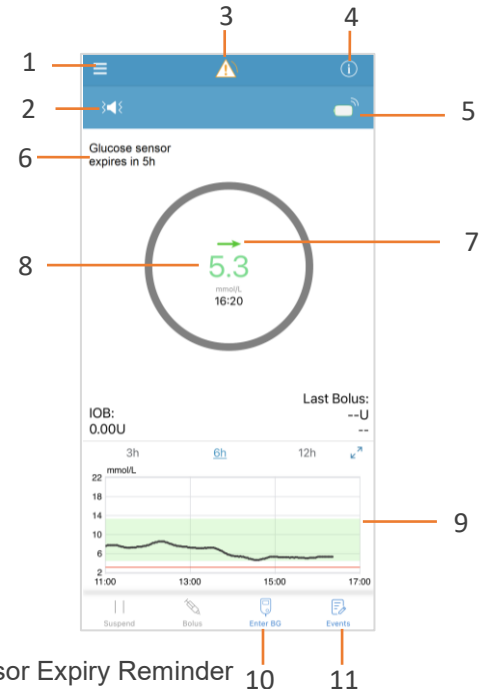

1. Main Menu
2. Audio Options
3. Alarm/Alert
4. Status
5. CGM RF Signal

6. Sensor Expiry Reminder
7. Sensor Trend Arrow
8. Last CGM Reading
9. Sensor Trend Graph
10. Calibration
11. Add Event

1. Sensor life

The expiration date is fixed at 14 days.



3. Add Transmitter SN

Main Menu → Settings → CGM System

Tap **+Add Transmitter** to add Transmitter SN



a. You can use the camera to scan the QR code on the back of your Transmitter or on the product box label.

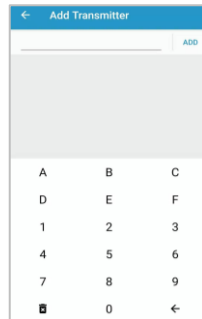

A	B	C
D	E	F
1	2	3
4	5	6
7	8	9
0		←

b. You can also tap **Enter SN manually** to enter the SN manually.

2. Find Transmitter SN

You can find the Transmitter SN on the product box label or on the back of the Transmitter.



4. Accept Remote View Request

Main Menu → Settings → Account Security
→ Remote View Permission

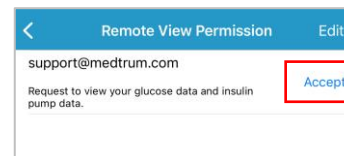

Tap **Accept** to grant permission for the remote view request.

Alerts Settings

Main Menu → EasyLoop → Glucose Alerts

Turn on/off Alerts



Rate Rise/Fall

Choose or customize the glucose change rate



Glucose Limits

Set up to 8 segments for each day

Start	Low Limit	High Limit (mmol/L)
00:00	4.4	13.3
+ Add Time Segment		

High/Low Predicted Alerts

You will be reminded of a predicted high or low glucose value some time (the predictive alert time) in advance

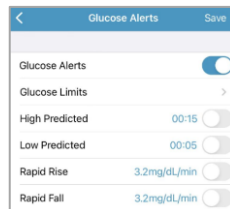

Repeat

Alerts may repeat if not cleared (tap **OK** for pop-up reminder or open the app when alert occurs). You can adjust the repeat time in the alert settings.

Repeat ?

00:10

Snooze

Alerts may repeat even after being cleared (tap **OK** for pop-up reminder or open the app when alert occurs). You can adjust the snooze time in the alert settings.

Snooze ?

00:15

1 Select an insertion site

- Ensure the area is clean, with no sweat, moles, scars, irritation, or tattoos. If the area has excessive hair, consider trimming it.
- Select an area with at least 5 mm of subcutaneous fat.
- For insertion on the back of the upper arm, apply the sensor vertically.
- For insertion on the upper buttocks (children only), apply the sensor horizontally.

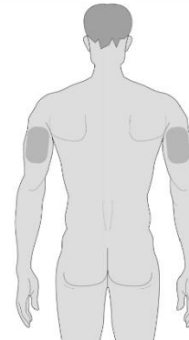

Recommended insertion sites:

- Back of the upper arm
- Upper buttocks (children only)



Note: Please pay attention to the location of the Sensor site and Patch site so that there is little communication interruption.

2 Prepare the insertion site

- Wipe the selected insertion area with rubbing alcohol and wait for the area to dry up.
- The Sensor adhesive stays more firmly on dry skin.

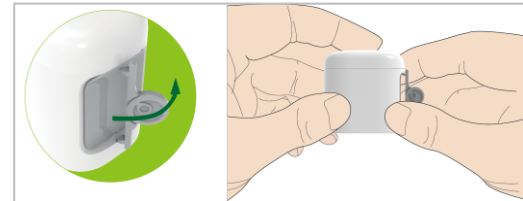

3 Place the Sensor

- Use your thumb and finger to bend off the safety lock by pushing it to the left or right.
- Remove the protective liners from the Sensor base.
- Place the Sensor on the selected site.

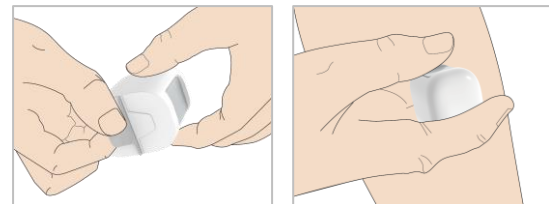

Apply Sensor

4 Insert Sensor needle

1. Place one finger on the top of the inserter and apply gentle downward pressure toward the skin to ensure the adhesive is securely attached to the skin.
2. While maintaining pressure, press the gray button firmly until you hear a “click” to insert the Sensor.

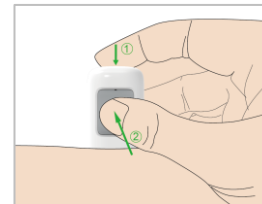

5 Remove Inserter

- Lift the inserter vertically away from the base.
- Only the Sensor base will be left on your body.
- Discard the sensor inserter into a sharp's container or a puncture-proof container with a tight lid.

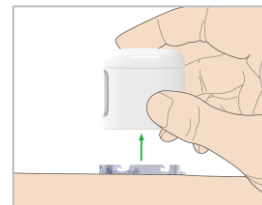

6 Connect Transmitter

- Keep the transmitter parallel to the Sensor base, then snap the transmitter into place.
- The indicator light will flash green 3 times first then another 6 times within one minute.
- Smooth the entire edge of the adhesive with your finger to eliminate any wrinkles.

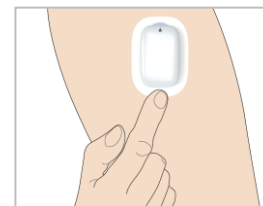
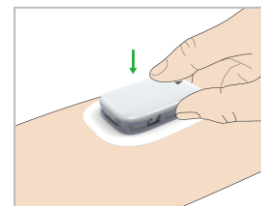

1. Connect Sensor with EasyPatch App

Main Menu → CGM → Connect Sensor

App automatically connects the sensor after adding transmitter SN.

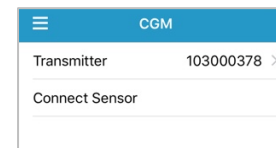

2. Enter the Sensor code

- If Factory Calibration is turned on, you can enter the sensor code by scanning the QR code or manually entering the 4-digit code on the sensor product box label, then the calibrations aren't required.
- If the sensor code is not entered, the sensor need to be calibrated twice on the first day.

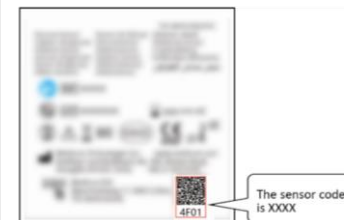

3. Sensor Warm-up

- When connected, the sensor will go through a warm-up period that may last up to 30 minutes.

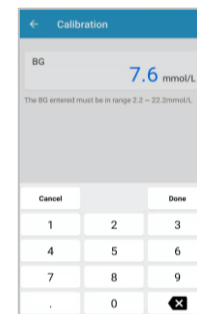
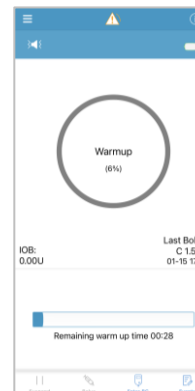

4. Calibrate the Sensor

- Tap the calibration button  at the bottom of the monitor screen.

Read CGM

CGM Functioning Calibration Required

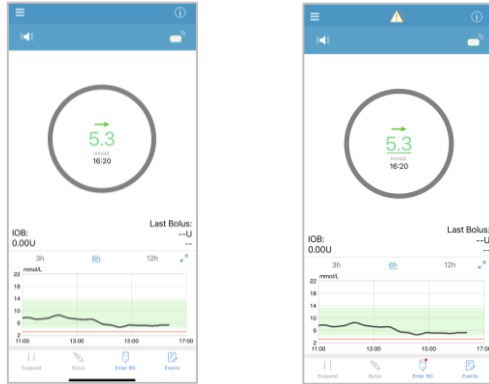

Sensor Trend Graph

Tap the corresponding tabs at the top of the sensor graph to view the trend graph for 3-hour, 6-hour, or 12-hour intervals.

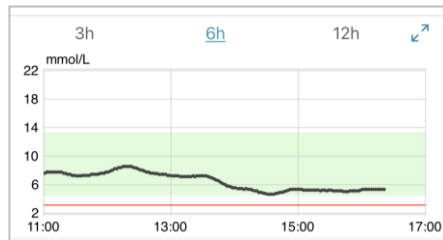

Alert



App Message	Actions to Take
CHARGE TRANSMITTER	Charge Transmitter.
TRANSMITTER ERROR	Call customer support.
NO READINGS	Change Sensor if it is not properly inserted. Otherwise, wait until the reading recovers.
SENSOR EXPIRED	Change Sensor.
SENSOR FAILURE	Change Sensor.
METER BG NOW	Enter new meter BG for calibration or tap OK to clear the alert.
SENSOR CAL ERROR	Enter meter BG after 15 minutes.
LOW GLUCOSE	Check blood glucose and treat it as necessary. Continue to monitor blood glucose.
LOW PREDICTED	Check blood glucose and treat it as necessary. Continue to monitor blood glucose.
RAPID FALL	Monitor trend and glucose level. Follow instructions from your healthcare provider.
BELOW 3.1 mmol/L	Check blood glucose and treat it as necessary. Continue to monitor blood glucose.
SENSOR EXP IN 6 HOURS	Change Sensor in 6 hours.

Special Conditions

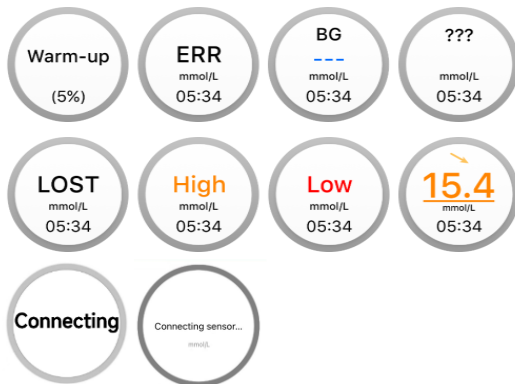

- **Warm-Up** - The Sensor is warming up.
- **ERR** - The Sensor shall be recalibrated after 15 minutes.
- **BG** - The Sensor shall be calibrated now.
- **???** - No readings. Do not remove the Sensor until you get "Sensor Failure" Alert.
- **LOST** - Sensor signal has been lost for more than 10 minutes. Wait for a while.
- **HIGH** - Sensor glucose is above 22.2 mmol/L (400mg/dL).
- **LOW** - Sensor glucose is below 2.2 mmol/L (40mg/dL).
- **Underlined reading** - Calibration overdue. A new meter BG is needed for calibration .
- **Connecting** - If this message remains for long time, it indicates Bluetooth communication issue or incorrect SN.
- **Connecting Sensor** - If this message remains for long time, it indicates sensor insertion failure.

Sensor Trend Arrows

The trend arrow shows the speed and direction of your sensor glucose readings.

	Stable
	Slowly rising or falling
	Rising or falling
	Rapidly rising or falling
No arrow	No information

Disconnect Sensor

Disconnect Sensor

Main Menu → CGM → Disconnect Sensor

- Each Sensor session will end automatically after 14 days. After that, you can remove the Sensor from your body.
- If you want to remove a Sensor before its expiration, you must disconnect it from your EasyPatch App first.

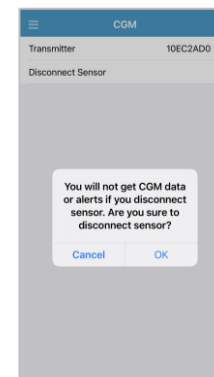

Remove the Sensor

- Gently peel off the adhesive pad in one motion to remove the Sensor and Transmitter.
- Hold the tab on the Sensor base and fold it down to break the base.
- Using your thumb, push the Transmitter slightly forward in a horizontal direction to separate it from the base.
- Gently pull the Transmitter away from the Sensor base.
- Remember to keep the reusable Transmitter. It is recommended to charge the Transmitter after each Sensor session. Make sure the Transmitter was disconnected from the old Sensor over 90 seconds before it is connected to a new one.

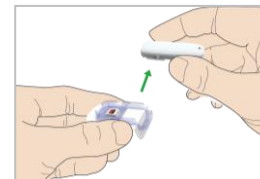
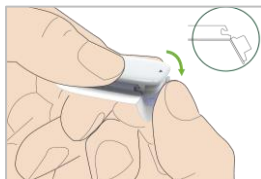

Daily Sensor Report

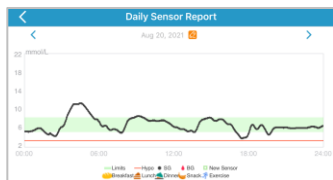

If you want to view a graph in landscape mode, tap the . Long press (1s) in the graph area of the graph, the cursor axis appears.

Sensor Overlay (iOS)

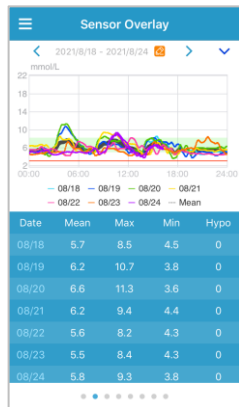

All the daily SG curves are displayed in an overlap graph so that you can easily see the pattern of glucose levels in given period.

Trend Analysis



Trend analysis shows the sensor reading trend in the last 7/30/90 days.

You can view the glucose data by either tapping and selecting a day or tapping to move back / forward.



Event Summary

Date	BG Test #/Mean (mmol/L)	Carbs #/Total (g)	Insulin Injection (U)	Exercise #/Duration
02/28	---	---	---	---
03/01	---	---	---	---
03/02	---	---	---	---
03/03	---	---	---	---
03/04	1/78	1/45	---	---
03/05	---	---	---	---
03/06	---	---	---	---
Overall	1/78	1/45	---	---

Event summary shows an overview of your event inputs.





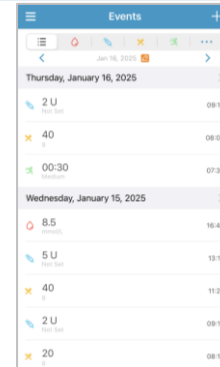

Events and Personal Reminder

Main Menu ➔ Event

This screen shows all the events before a certain date which can be changed by tapping  and selecting a day or tapping  /  to move back / forward.



Add an event

1. Tap  to add a new event.
2. Tap      to add BG, injection, food carbs, exercise or other events.

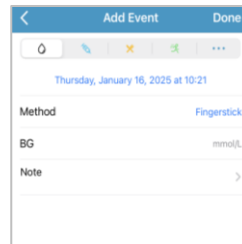

Edit events

1. Select a previous entered event.
2. Tap **Done** to save or tap **Delete** to delete an event.

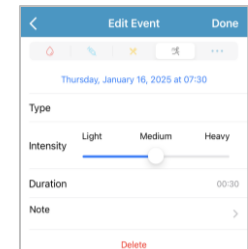

Personal Reminder (For iOS device only)

The personal reminders can be useful to remind you when to check your blood glucose, delivery bolus etc.

Tap  to add a reminder,
Slide a reminder from right to left and tap **Delete** to delete it.

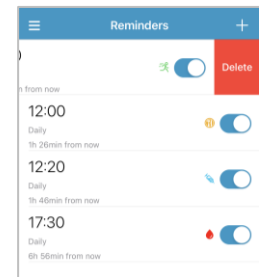
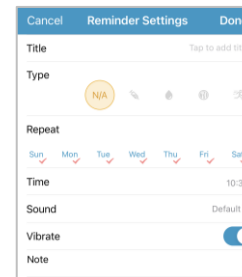
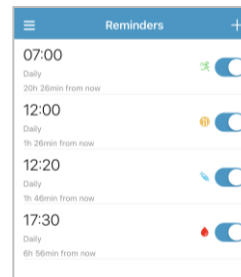

Your Personal CGM Settings

Glucose Alerts

☐ ON ☐ OFF

Glucose Limits (mmol/L)

Start Time	Low Limit	High Limit
:		
:		
:		
:		
:		
:		
:		
:		

Predictive Alerts

Type	Status / Time	
High	<input type="checkbox"/> ON _____	<input type="checkbox"/> OFF
Low	<input type="checkbox"/> ON _____	<input type="checkbox"/> OFF

Rate Alerts (mmol/L/min)

Type	Status / Rate	
Rise	<input type="checkbox"/> ON _____	<input type="checkbox"/> OFF
Fall	<input type="checkbox"/> ON _____	<input type="checkbox"/> OFF

Repeat/Snooze

High	/
Low	/
Others	/



Medtrum Technologies Inc.
7F, Building 8, No. 200 Niudun Road,
Free Trade Zone, Shanghai, 201203, China
Tel: +86-21-50274781



Medtrum B.V.
Hallenweg 24
5683 CT Best
The Netherlands
Tel: +31 (0) 499745037



IM889017WW-004
348504
Version: 2.02

Simplifying Diabetes

Medtrum